

CDS13 BYPASS SLIDING DOOR KIT (soft closing)

GLASS FABRICATION

Use 5/16" or 3/8" (8 or 10 mm) Tempered Glass only.

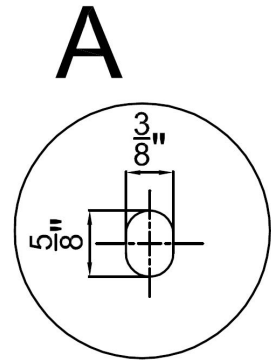
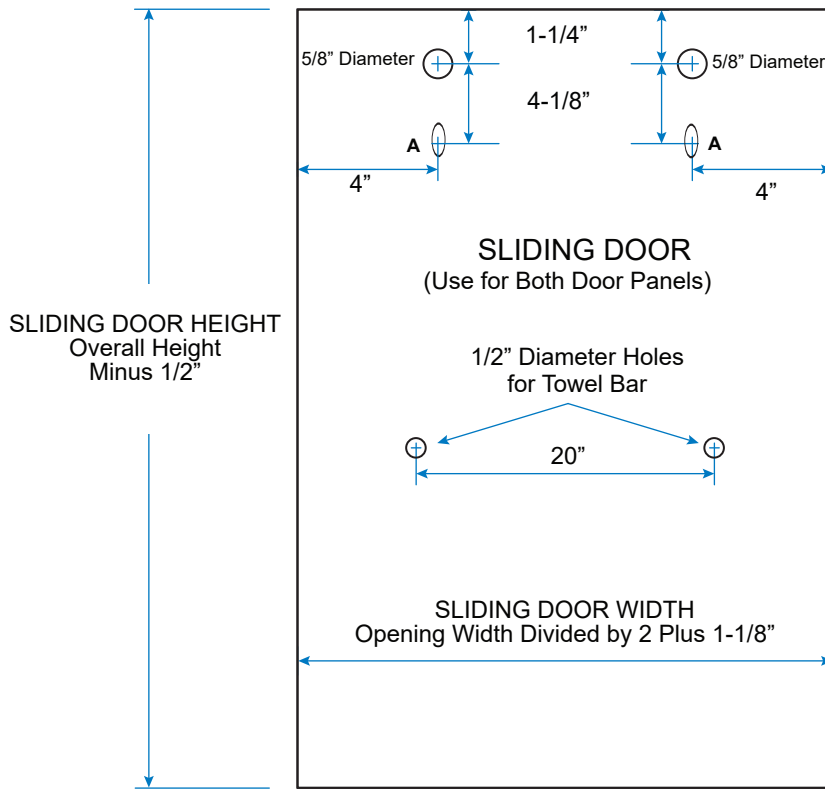

TOWEL BAR POSITION

Position Towel Bar vertically to customer's desired height.

Centered horizontally is suggested position.

SLIDING DOOR HEIGHT: Overall Height minus 1/2"

SLIDING DOOR WIDTHS: Overall Width divided by 2, plus 1-1/8"

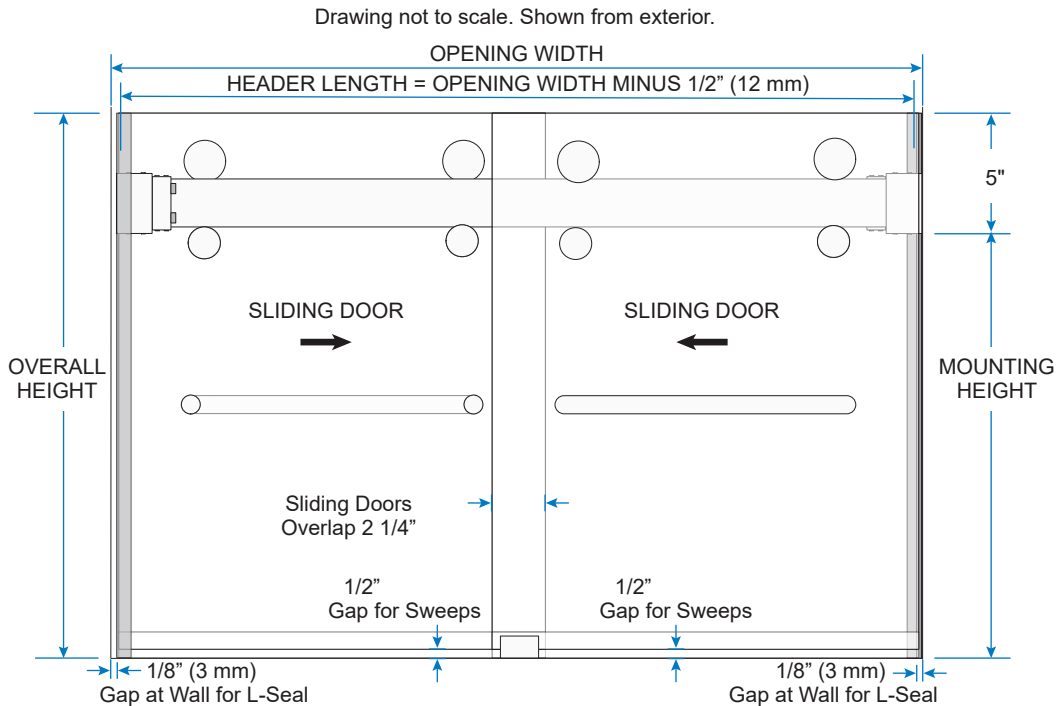

NOTE: Drawings not shown to scale. Header Bar is cut 1/2" (12 mm) less than Opening Width. Use wall-to-wall tight dimension. Overall Height is height from curb/floor to top of glass.